

General functions and range of applications, intended use

The drainage electric sump pumps “Derby Ex” series are electrical pumps single-impeller with vertical axis and can be used, among the others, for the following purposes:

- emptying rainwater wells collection and infiltration;
- draining of flooded areas;
- raising of water from deep wells, bathtubs and tanks of first collection;
- waterworks of raising for industrial uses;
- sewage system and/or cesspool;
- collecting of leachate in storage tanks;
- removal of condensed water in biogas plants;

The liquids handled can contain solid particles small and average dimension (maximum 10 mm) and/or filamentous particles.

The “Derby Ex” pumps series can normally be used with liquids having from Ph 6 to Ph 14.

Rated data and performances

- rated voltage: 400V₃; 230V₁₋₂; ± 5%
- connection: star
- rated frequency: 50 Hz
- rated speed: 2850 rpm
- insulation class: F (Δt F)
- maximum altitude of duty: 1000 m a.s.l.
- liquid temperature : -20 ÷ +40°C
- liquid density: < 1200 kg/m³
- I_A/I_N: 3,8

In order to guarantee the correct operation of the hydraulic parts of the drainage electric submersible pumps “Derby Ex” series, assured that the minimum delivery capacity is at least 5 l/min.

Construction materials

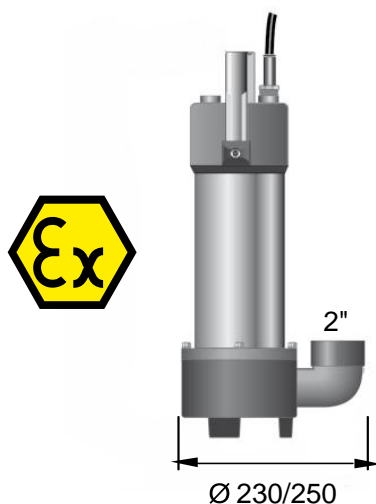

Pump type	Component	Material
Derby EX	Gaskets	NBR
	Mechanical seal	NBR/Aluminum oxide/ Graphite/SS304
	Cast iron	G25
	Cable	SK or H07RN-F
	Motor case	Stainless steel AISI304
	Bearings support	Cast Iron G25
	External hydraulic part	Cast Iron G25
	Impellers/diffuser	Cast Iron G25

Sample of application

Intrinsically safe active barrier
for Atex level regulator

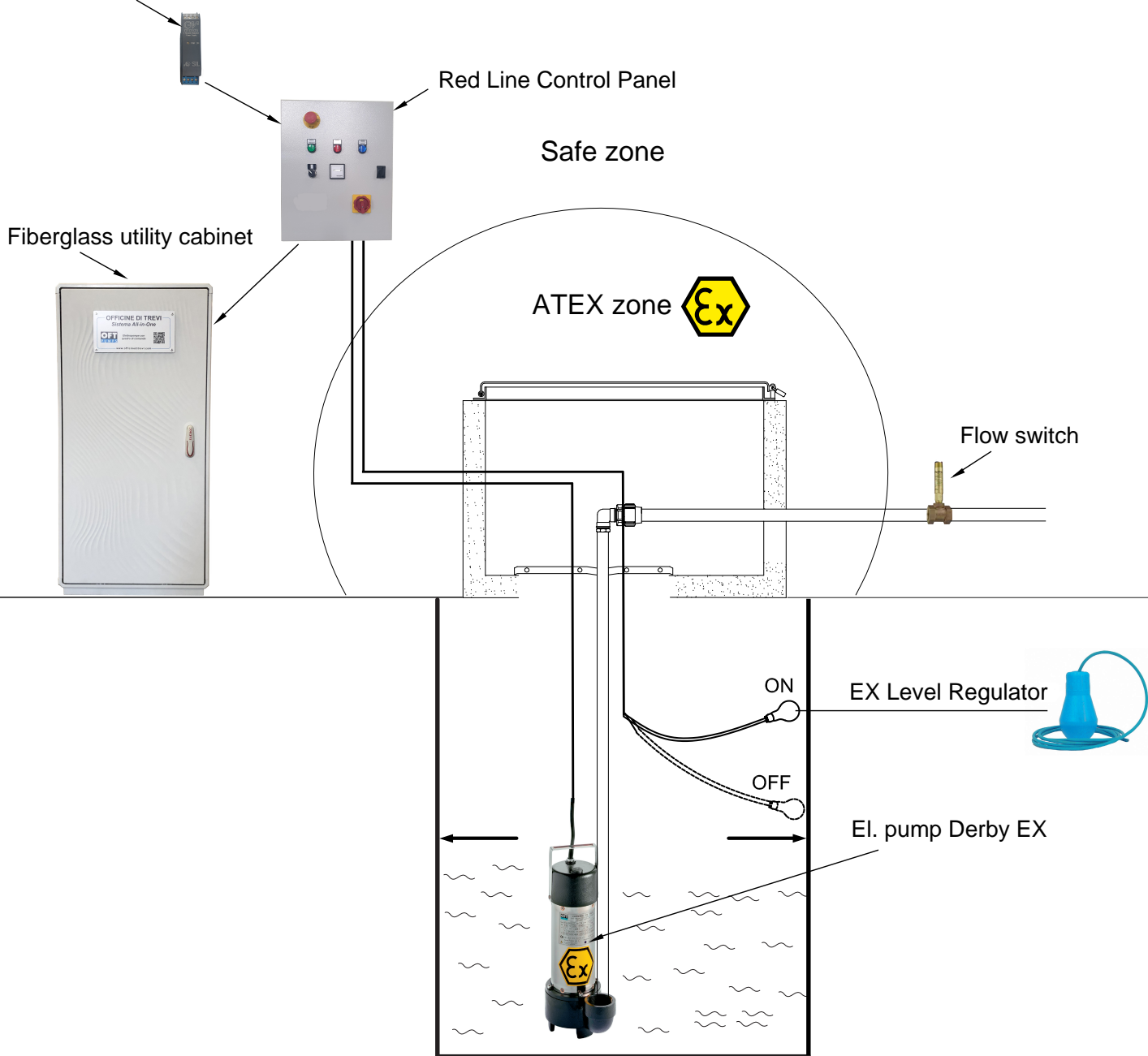

<https://prom-nasos.pro>

<https://bts.net.ua>

<https://prom-nasos.com.ua>

+38 095 656-37-57,

+38 067 360-71-01,

+38 063 362-12-31,

info@prom-nasos.pro